

# SM 1250

DIN 464

# Rändelschraube hoch

Knurled screw, high

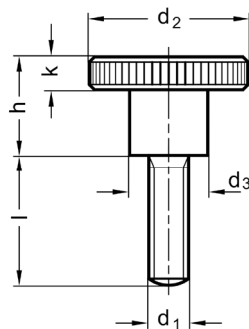

Catalog No.	d <sub>1</sub>	X	l	Material
SM 1250	M03	X	16	NI

**STV:** Stahl Festigkeitsklasse 5, verzinkt  
**STB:** Stahl Festigkeitsklasse 5, brüniert  
**NI:** Edelstahl rostfrei 1.4305, matt gestrahlt  
**STV:** steel, tensile strength class 5, zinc plated  
**STB:** steel, tensile strength class 5, blackened  
**NI:** stainless steel 1.4305, matte shot-blasted



Gewinde bis zum Kopf, Kopffläche feingedreht  
 thread up to the head, visible face fine turned



**MS:** Messing  
**MS:** brass



mm



RoHS Konform Compliant

d <sub>1</sub> ∅	l	d <sub>2</sub> ∅	d <sub>3</sub> ∅	h	k	kg
M02	04	9	4,5	5,3	2,0	0,002
	06					0,002
	08					0,003
	10					0,004
M02,5	04	11	5	6,5	2,5	0,002
	06					0,003
	08					0,003
	10					0,004
M03	06	12	6	7,5	2,5	0,003
	08					0,004
	10					0,004
	12					0,005
	16					0,005
	20					0,006

d <sub>1</sub> ∅	l	d <sub>2</sub> ∅	d <sub>3</sub> ∅	h	k	kg
M04	05	16	8	9,5	3,5	0,007
	08					0,008
	10					0,008
	12					0,009
	16					0,009
	20					0,010
M05	06	20	10	11,5	4,0	0,014
	08					0,015
	10					0,015
	12					0,016
	16					0,016
	20					0,017

d <sub>1</sub> ∅	l	d <sub>2</sub> ∅	d <sub>3</sub> ∅	h	k	kg
M06	08	24	12	15,0	5,0	0,027
	10					0,028
	12					0,028
	16					0,028
	20					0,029
	25					0,030
	30					0,031
M08	12	30	16	18,0	6,0	0,055
	16					0,056
	20					0,057
	25					0,058
	30					0,060
	35					0,062
	40					0,063
M10	12	36	20	23,0	8,0	0,106
	15					0,107
	20					0,109
	25					0,111
	30					0,113
	35					0,116
	40					0,117

# SM 1251

DIN 466

# Rändelmutter hoch

Knurled nut, high

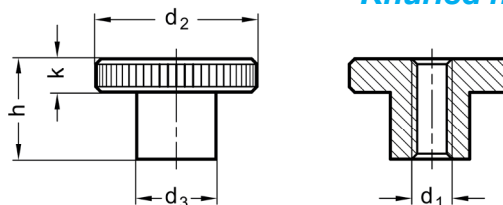

Catalog No.	d <sub>1</sub>	Material
SM 1251	M03	STV

**STV:** Stahl Festigkeitsklasse 5, verzinkt  
**STB:** Stahl Festigkeitsklasse 5, brüniert  
**NI:** Edelstahl rostfrei 1.4305, matt gestrahlt  
**STV:** steel, tensile strength class 5, zinc plated  
**STB:** steel, tensile strength class 5, blackened  
**NI:** stainless steel 1.4305, matte shot-blasted

\*) nicht im amtlichen Normblatt enthalten  
 not part of the German Standard DIN

Kopffläche feingedreht  
 visible face fine turned

**MS:** Messing  
**MS:** brass



mm



RoHS Konform Compliant

d <sub>1</sub> ∅			d <sub>2</sub> ∅	d <sub>3</sub> ∅	h	k	kg
STV	STB	NI	∅	∅			
M02	M02	M02	9	4,5	5,3	2,0	0,002
M02,5	M02,5	M02,5	11	5	6,5	2,5	0,003
M03	M03	M03	12	6	7,5	2,5	0,003
M04	M04	M04	16	8	9,5	3,5	0,007
M05	M05	M05	20	10	11,5	4,0	0,013
M06	M06	M06	24	12	15,0	5,0	0,023
M08	M08	M08	30	16	18,0	6,0	0,044
M10	M10	M10	36	20	23,0	8,0	0,087
M12*	M12*	M12*	40	22	25,0	10,0	0,118

